

Corner Protectors (inner) £12.00

These parts fit to the inner corner brackets, they offer added protection for particularly adventurous cats (Houdinis) that might attempt to escape via these points.

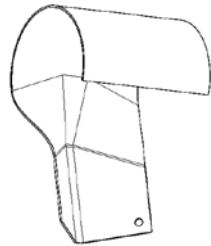

End Protector (Right/Left) £12.00

These parts fit to the outer corner brackets or to the single sided double brackets, they offer added protection for particularly adventurous cats (Houdinis) that might attempt to escape via these points.

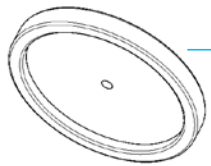

Drilling Jig £12.00

Tool used as a guide to ensure the correct location of the 10mm axle holes in the end of the Katzecure poles.

Additional Pole System

These versatile components can be used to fit a pole over a window ledge, or to add an additional fence top pole where added security is desired.

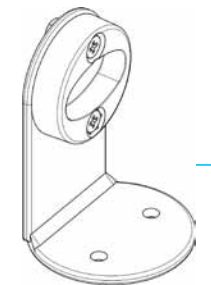

Single-sided Single Bracket £10.00

One simple bracket fitted with a single Standard Runner, designed for fitting at the end of a single pole run.

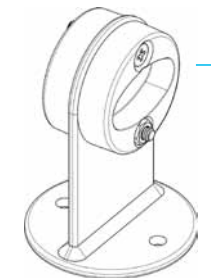

Double-sided Double Bracket £11.00

One simple bracket fitted with two Standard Runners, designed for fitting in the middle of a single pole run.

How Katzecure works

The Katzecure system works by attaching one or two wooden pole systems to existing garden fences and walls. On contact these poles rotate preventing the necessary 'pawhold' to be gained to scale and jump over.

We have designed the:

- Single Pole system – for less agile breeds
- Double Pole system – for agile breeds

The Katzecure system is available directly from us as a DIY or as a full installation service. We conduct a garden survey to assess in detail all requirements and provide a fully costed quotation. We can also provide prices from measurements and photographs provided by you.

To make a garden secure for cats the following components are required:

- Brackets (single, double, corner, etc)
- Axles (standard or deluxe)
- Pole-end sleeves (to ensure continuous run)
- 75mm diameter machine round poles
- Gravel board – to fix the system to the fence
- Trellising/Meshing – to raise fence heights or secure gaps as appropriate

We can also manufacture custom made components to secure awkward angles and gaps.



**Price list
for Katzecure
component parts**



Katzecure Limited
Howards Nursery Centre, Handcross Road,
Plummers Plain, Horsham, West Sussex RH13 6NX

Phone: 0800 345 7003 Mobile: 07764 831133
E-mail: information@katzecure.com

For more information visit:
www.katzecure.com

2013/14

Price list for Katzecure component parts

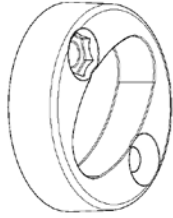

Standard Runner £5.00

Two 40mm roller supports, for surface or rebate mounting.

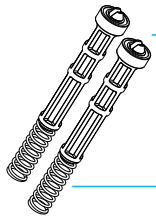

Standard Axle £5.00

Two 10mm axles with plastic bearing and retainer springs.

Deluxe Axle £10.00

Two 10mm axles with ball race and retainer springs.

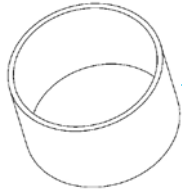

Sleeves £7.00

Two tubes that are fixed to the ends of the poles and cover the Axle and Runners. These provide an almost continuous pole along the fence top.

Standard Pole £11.00

Standard 1.83 meter (6 foot) long, 75 mm (3 inch) diameter, machine round wood pole.

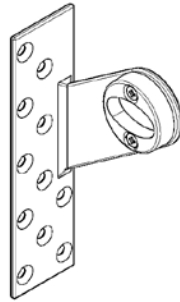

Top or Internal System brackets.
Please Note: that the images are of the Internal System only.

Single Sided Single Bracket £12.50

One simple bracket fitted with a single Standard Runner, designed for fitting at the end of a single pole run. (Bracket shown is right hand).

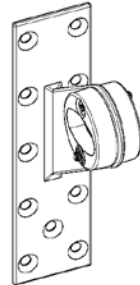

Double Sided Single Bracket £15.00

One simple Bracket fitted with two Standard Runners, one each side of the bracket, designed for fitting in the middle of a single pole run.

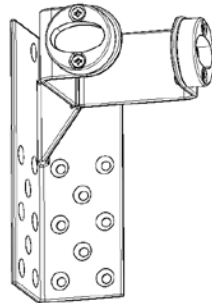

Inner Corner Single Bracket £20.00

One bracket fitted with two standard runners to turn a 90-degree inwardly facing corner.

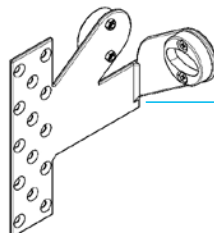

Outer Corner Single Bracket £20.00

One bracket fitted with two standard runners to turn a 90-degree outward facing corner.

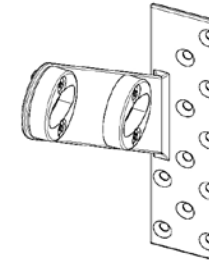

Top, Internal or Staggered System, Double Pole Brackets
Please Note: that the images are of the Internal System only.

Single Sided Double Bracket £14.00

One simple bracket fitted with two Standard Runners, both on the same side, designed for fitting at the end of a double pole run. These are 'handed' either left or right as you view the poles (Bracket shown is left hand).

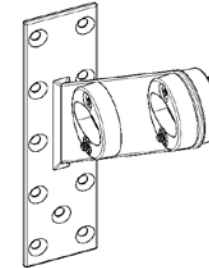

Double Sided Double Bracket £16.00

One simple bracket fitted with four Standard Runners, two on each side, designed for fitting in the middle of a double pole run.

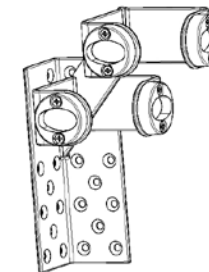

Inner Corner Double Bracket £25.00

One bracket fitted with four standard runners to turn a 90-degree inwardly facing corner.

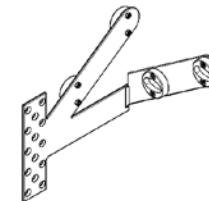

Outer Corner Double Bracket £25.00

One bracket fitted with four standard runners to turn a 90-degree outward facing corner.